

## USE AND CARE GUIDE

### Multifunctional DIY LED Magnetic Sensor Light Kit (MDLS)

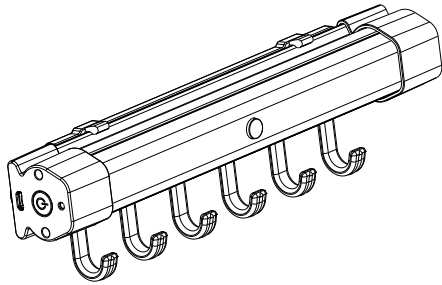









#### THANK YOU





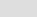

We appreciate the trust and confidence you have placed in us through the purchase of MDLS. We strive to create quality products designed to enhance your home and make living simpler. Visit us online to see our full line of products available for your home improvement needs. Thank you for choosing us.

## Safety information

Please read carefully before attempting to assemble, install, operate or maintain MDLS herein after referred to as "the product" or "the light". Protect yourself and others by observing all safety information. Failure to comply could result in personal injury and/or property damage! See this instructions manual for future reference.

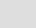
-  **CAUTION:** Do not stare directly into the product when it is turned on, as the light is designed with a high brightness mode that may harm the eyes.
-  **CAUTION:** Do not puncture or dismantle the light, and replace the rechargeable battery. Adhere to instructions contained in this manual for installing and replacing the AAA dry cell alkaline batteries.
-  **CAUTION:** Do not use light in dusty and humid environments like bathrooms; and do not use when your hand is wet. This is not a water and dust proof light.
-  **CAUTION:** Keep the product away from fire, corrosive and/or explosive gas and materials, hot steaming areas, sparks, dusty areas and electronic devices, including magnetized devices that may distort the light's function, or cause damage.
-  **CAUTION:** Avoid dropping the light, as damage to the PC cover, the end cap or other components can occur.
-  **CAUTION:** Use the 1A charging cable with appropriate DC 5V 1A (not included) charger to charge the light to achieve efficient charging time.
-  **CAUTION:** Do not use the light when it is charging.
-  **CAUTION:** Do not block the sensor when using this light in the sensor mode.
-  **CAUTION:** Do not push the sensor to avoid damage to it.
-  **CAUTION:** Always take care to insert the batteries correctly following the guide in the operation section of this instruction manual. Incorrectly inserted batteries may short-circuit leading to leakage and explosion.

## Safety information (continued)

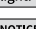
-  **CAUTION:** Do not short-circuit the batteries. When positive (+) and negative (-) terminals of the batteries come into direct contact with each other, short-circuit can occur. This leads to instant flow of excess current between the batteries, which results in heat generation and damages the internal structure of the batteries.
  -  **CAUTION:** Do not charge the AAA dry cell alkaline batteries specified for use in this light. Doing so leads to leakage and explosion.
  -  **CAUTION:** Do not mix batteries. When replacing the batteries, replace all of them at once with new batteries of the same brand and type. Using different kinds of batteries together or using old and new batteries together may result in leakage and explosion, because some batteries may be overdischarged already.
  -  **CAUTION:** If the hook panel is installed with screws, it would be held permanently on the spot it is fixed. Do not attach the panel with screws at a place you do not want to have it permanently.
  -  **CAUTION:** When the hook panel is installed with suction cup, follow tips listed under the suction cup installation to avoid accidental drop and damage to the light components and other items around the light. See installation guide below.
  -  **CAUTION:** Strictly follow our installation guide when fixing the hook panel with double-sided adhesive strip to ensure the panel holds tight on the surface and avoid accidental drop and damage to the light components.
  -  **CAUTION:** The maximum loading for single hooks and the whole panel are 300g and 1kg respectively for any installation. Overloading may cause the deformation of the hook and/or the detachment of the panel and damage the items underneath.
- NOTICE:** Prolonged usage of the light may increase the temperature of the light. This is normal and will not cause damage to the product or hurt user.
- NOTICE:** Always follow the good practice of charging the light, which contains Li-ion battery to its full capacity before operation or prolonged storage. To maintain the proper functionality of the light, it is recommended to charge it once every three months.

## Safety information (continued)

- NOTICE:** Ensure to use the recommended AAA dry cell alkaline batteries for the optimum performance of this light.
- NOTICE:** When using the AAA dry cell alkaline batteries, the lumen drops as the battery voltage level drops. This is a common feature of AAA dry cell alkaline batteries, and it does not mean the light is faulty in any way.
- NOTICE:** When using AAA dry cell alkaline batteries, if the light drops or is hit by an object there may be a chance the light will go off. Ensure the batteries are well placed and turn on again.
- NOTICE:** It is recommended to stop using the light after three years, as some electronic components may begin to age and cause minor malfunction.
- NOTICE:** Ensure to remove the AAA dry cell alkaline batteries from the light, when it is not used for a long time.
- NOTICE:** When Li-ion battery is charging, it does not charge AAA dry cell alkaline batteries at all as their circuits are separate.
- NOTICE:** This equipment has been tested and found to comply with the limits for a Class B digital device, pursuant to Part 15 of the FCC Rules. These limits are designed to provide reasonable protection against harmful interference in a residential installation. This product generates; uses and can radiate radio frequency energy and, if not installed and used in accordance with the instructions, may cause harmful interference to radio communications. However, there is no guarantee that interference will not occur in a particular installation. If this equipment does cause harmful interference to radio or television reception, which can be determined by turning the equipment on and off, the user is encouraged to try to correct the interference by one or more of the following measures:
- Reorient or relocate the receiving antenna.
  - Increase the separation between the equipment and receiver.
  - Connect the equipment into an outlet on a circuit different from that to which the receiver is connected.
  - Consult the dealer or an experienced radio/TV technician for help.
- NOTICE:** This product complies with Part 15 of the FCC Rules. Operation is subject to the following conditions:  
(1) This device may not cause harmful interference, and  
(2) This device must accept any interference received, including the interference that may cause undesired operation.

## Limited warranty

The manufacturer warrants this product free from defects in materials and workmanship for a period of one (1) year from date of purchase (Please register and validate the warranty at [www.qee.hk](http://www.qee.hk) within 7 days of the purchase). This warranty applies only to the original consumer purchaser and only to products used in normal use and service. If this product is found to be defective, the manufacturer's only obligation, and your exclusive remedy, is the repair or replacement of the product at the manufacturer's discretion, provided that the product has not been damaged through misuse, abuse, accident, modifications, alterations, neglect or mishandling. This warranty shall not apply to any product that is found to have been improperly set-up or used in any way not in accordance with the instructions supplied with the product. This warranty shall not apply to a failure of the product because of an accident, misuse, abuse, negligence, alteration, or faulty installation, or any other failure not relating to faulty material workmanship. The manufacturer specifically disclaims any liability and shall not be liable for any consequential or incidental loss or damage, including labor/expense costs involved in the replacement or repair of said product.

## Pre-installation

### Product specifications

|                                 |  |
|---------------------------------|--|
| Model no.                       | MDLSD020                                 |
| Input, voltage and current      | DC5V 1A                                  |
| LED                             | 22pcs                                    |
| Battery source                  | Dual: Li-ion/dry cell                    |
| Li-ion battery capacity         | 2000 mAh                                 |
| Dry cell battery (not included) | 3 x 1.5V AAA dry cell alkaline batteries |
| Charging time                   | 3±1H                                     |
| Sensor distance                 | 0-3 meters                               |
| Sensor delay                    | 20-30 seconds                            |
| Light size                      | 233mm x 34.5mm x 38.6mm                  |
| Weight                          | 200±10g                                  |
| CCT                             | 6500±500k                                |
| CRI                             | >80                                      |
| Luminous angle                  | 105°                                     |

| Model no. MDLSD020                        | High  | Medium | Low   | Saving |
|---|---|--------|-------|--------|
| Lumen                                     | >320Lm  | >160Lm | >80Lm | >40Lm  |
| Estimated Wattage                         | <3.2W   | <1.6W  | <0.8W | <0.4W  |
| Runtime (AAA dry cell alkaline batteries) | We recommend high quality AAA dry cell alkaline batteries, as the discharge time varies according to the quality of the battery brand |        |       |        |
| Runtime (Li-ion battery)                  | 2-3H  | 4-5H   | 8-9H  | 16-18H |

The discharge and charging time are tested under standard environment, i.e. room temperature 25 ± 1°C, ambient humidity 40% - 60% RH. The actual use will vary according to different conditions.

### Package contents

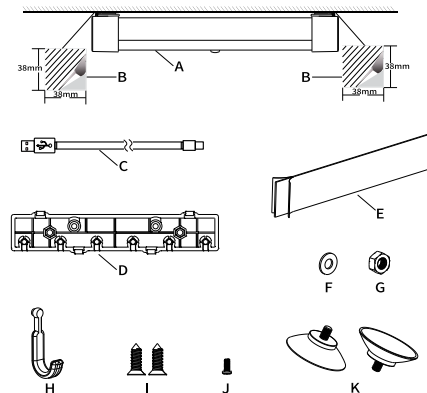

## Installation

| Part | Description                            | Quantity |
|------|--|----------|
| A    | LED light                              | 1        |
| B    | Adhesive strip pads                    | 2        |
| C    | 1A Charging cable                      | 1        |
| D    | Hook panel                             | 1        |
| E    | Double-sided adhesive fastener         | 1        |
| F    | Metal-washer                           | 2        |
| G    | Bolts                                  | 2        |
| H    | Hooks (1 spare)                        | 7        |
| I    | Screws (for wooden surface attachment) | 2        |
| J    | Tiny screw for battery chamber lock    | 1        |
| K    | Suction cups                           | 2        |

### Tools required



### 1 Fitting hooks into the hook panel

- Carefully place the hooks into the marked hook holders on the hook panel.

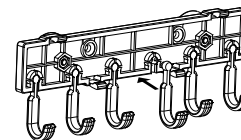

### 2 Attaching suction cups into the hook panel

- The hook panel comes with a space for attaching suction cups with the aid of two bolts.
- Place two bolts (provided) into the bolt holder on the front side of the panel.
- Screw the suction cups into the bolts from the back of the panel until firmly attached.

- Place on mirrors and other smooth surfaces.
- Clean the surface for mounting the suction cups thoroughly with a damp, clean cloth; as the suction cups will not stick on dirt or dust.
- Rinse the back of the suction cup with warm water to remove any residual dust that may be on the edges of the cup, then dry it thoroughly with towel or allow it to air dry.
- Wet the tip of your finger and rub your finger over the inside of the edge of the cup, to help it create a seal.
- Gently press the suction cup against surface it is to be mounted, hold the cup in place for 15 seconds.
- Slowly release the suction cup and it will build a vacuum and hold fast.
- Ensure the surface for placing the suction cups is very smooth, as in a mirror, to avoid dropping.

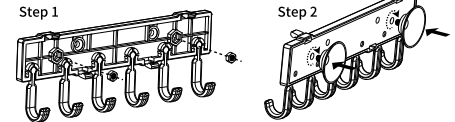

### 3 Attaching double-sided adhesive tape to the hook panel

- Ensure the surface to attach the adhesive tape is clean.
- Peel off the thin film on one side of the adhesive fastener.
- Place it on the back of the hook panel.
- Peel off the thin film on the other side and stick to any desired surface, press it firmly on the surface.
- It is recommended to let the adhesive tape hold the hook panel for 24 hours before placing the light on it, to ensure it has been tightly glued to the surface.

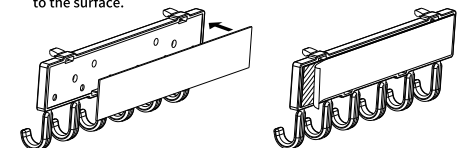

## Installation (continued)

### 4 Fixing the hook panel with screws (permanent fix)

- The hook panel comes with two holes for screws.
- Identify the position to place the light.
- Measure the distance from one hole to the other with a ruler, mark out the screw points on the mounting surface using the same measured distance.
- Ensure the screw is not longer than the thickness of the surface for mounting the panel. Otherwise it may come out on the other side of the surface.
- Attach the hook panel using the provided screw.
- Drive the short screw directly into the wooden surface with a screwdriver.

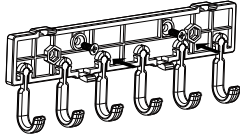

### 5 Fixing with adhesive strip pads

- Make sure the surface to glue the adhesive strip is clean, it is recommended to wipe the surface with rubbing alcohol. Do not use household cleaners or water.
- Place the adhesive strip pads on the magnet on the end caps of the light.
- Peel off the liners on the glue and place the light on the desired spot, gently press it firmly to the surface.
- Remove the light and press the adhesive pads to the surface with your fingers. Allow for 24 hours for the adhesives to bond to the surface before placing your light on it again.
- If the surface for mounting the light is a ferrous metal, you need not use the adhesive strips. However, make sure the metal works well with magnets.

## Troubleshooting

| Problem   | Possible Cause   | Solution   |
|---|--|--|
| 1. The light becomes hot.                             | The light is operating outside of the normal temperature range.  | If the temperature of the body is higher than 122°F (50°C) return the light if it is still within the warranty period. |
| 2. The light gets warm after prolonged usage.         | This is normal and part of the expectations of the component parts of the light.                             | Keep using the light, the temperature will not result to any injuries or damage.                                       |
| The body of the light has some light scratches.       | Though the body of the light is made with hard PC and anti-glare material, it is still subject to scratches. | Handle the light with care, to avoid scratches on the surface.   |
| There are cracks in the magnet.                       | The light may have been dropped.   | Protect the end cap when using and handling the light.   |
| There are scratches in the light.                     | The light may have been dropped or stored with other items with rough surface.                               | Handle the light with care and always store it where it will not be exposed to scratches.                              |
| 1. The light does not switch on.                      | The battery level is low.  | Check the low battery indicator light. If the light is orange, charge the light to restore normal brightness.          |
| 2. The light is becoming dimmer than normal standard. |  | If your light runs on AAA dry cell alkaline batteries, consider replacing the batteries.                               |
| The light does not work under very cold conditions.   | The battery is cold.   | Keep the light in a warm environment above 32°F.   |

## Installation (continued)



### 6 Installing the light fixture

- Place the light on the hook panel installed with any of the options above.
- Do not attach or detach the light from the hook panel in a straight position, doing so will weaken the grip of the light holder on the panel and loosen the grip of the panel to the attached surface if it is installed with adhesive tape.
- Follow the directional movement illustrated below to attach and detach the light.
- Hang the light on objects using the hook on the end cap.
- Use the light in a handheld position for emergencies.

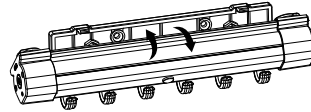

## Operation

The light functions in two battery modes – AAA dry cell alkaline batteries and Li-ion battery.

### 1 Installing the AAA dry cell alkaline batteries

- Unlock the AAA dry cell alkaline batteries compartment.
- Place the batteries into the chamber with the positive terminal facing the battery chamber lock.

## Troubleshooting (continued)

| Problem   | Possible Cause  | Solution   |
|---|---|--|
| The light requires more charging time and has a shorter runtime after a period of usage.  | The Li-ion battery life is depleted.  | The light will function at 70% capacity with longer charging times and shorter runtime. If this interferes with the performance you need for the light, purchase a new one.  |
| The charging time is longer than the normal charging time described in this manual.   | 1. The charger being used is not the same as specified in this manual.<br>2. The charging cable cannot accept 1A current. | Make sure the charger is DC5V 1A. If the charger is lower than 1A, it is normal for the charging time to be longer.<br>Check the charging cable for 1A current capability. If the cable cannot handle 1A current, replace with a different cable with that capability. |
| 1. The indicator light continues to flash one color and does not turn into the correct color as indicated.<br>2. The light does not change green according to the specifications above. | The charging cable is loose.<br><br>The indicator light is out of order.  | Adjust the charging cable to fit the charging port or replace with a new cable.<br><br>If the light is within the warranty period, return the light for a replacement.   |

## Operation (continued)

### 2 Charging the Li-ion battery

- When the indicator light is ORANGE, the battery is low.
- Connect the appropriate 1A charging cable to the light charging port with appropriate DC5V 1A charger (not included).
- The indicator light turns RED when the light starts charging.
- The indicator light turns GREEN when the battery is fully charged.
- It is recommended to use AAA dry cell alkaline batteries when the Li-ion battery is low to extend the runtime of the light, as both batteries will be expended concurrently when used together.
- The AAA dry cell alkaline batteries extends the light application in emergency situation without needing to charge.

### 3 Turning on the LED light

- The light can work in two modes – the automatic sensor mode and manual mode.
- While the light is on, press and hold the power button to switch to sensor mode. Red indicator light flashes thrice indicating sensor mode is activated.
- Also, while the light is on press the power button to exit sensor mode. The red indicator light flashes 2 times.

### Sensor mode

- The light comes on immediately it detects movement within the sensor range. No movement in sensor range, light goes off after around 20 seconds.
- The light has a memory function and comes on to the last used brightness level in manual mode when automatic sensor mode is activated.

### Manual mode

- Press the power button to turn on the light to the highest brightness level.

## Troubleshooting (continued)

| Problem   | Possible Cause   | Solution  |
|---|--|---|
| Lights stay continuously on.  | 1. A lamp is positioned too close to the sensor or pointed at nearby objects that trigger the sensor.<br>2. Light control is in manual mode. | Reposition the lamp away from the sensor or nearby objects.<br>Switch to automatic sensor mode. |
| The light sensor is not very sensitive.                             | The environment is too bright.   | Sensor works best in indoors setting, with ambient lighting surrounding, with lux less than 10. |
| The light flashes frequently when working in automatic sensor mode. | Other infrared (IR) devices may affect the light sensor function within a distance.  | Remove other devices affecting the light or place the light outside the interference range.     |

## Care and cleaning

- Before cleaning the light, make sure it is not connected to a power source.
- Wipe the light with a piece of white tissue or soft cloth when dirty.
- Avoid spraying water or any liquid on the light, especially at the charging port.
- Do not use solvents or cleaners containing abrasive agents when cleaning the light.
- Ensure to replace the AAA dry cell alkaline batteries at least once every 3 months, to avoid damage to the light.
- Use a brush with soft bristles to clear dust off the hooks and the panel when needed, you do not need to detach it and wash.
- Remove and attach the suction cups to the surface at least once in 3 months, to ensure it is firmly placed at all times.
- Always keep the light under the working temperature mentioned in this manual, for optimum performance and to avoid damage. See specifications.

## Operation (continued)

- To adjust brightness, press the power button continuously to select the desired brightness from the four levels available.
- To turn off the light, press power button continuously after the light is turned on until the light goes off.

### 4 Positioning the LED light

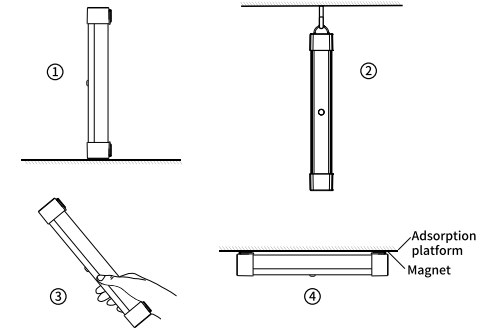

| Position | Description  |
|----------|--|
| 1        | Stand upright on flat surfaces.  |
| 2        | Use in a suspended position with hooks on both end caps.                           |
| 3        | Move freely in any hand-held position.   |
| 4        | Stick onto adsorption platform using the embedded magnets and adhesive strip pads. |



Questions, problems, missing parts? Before returning to the store, call our Customer Service 9 a.m. - 6 p.m., Monday - Friday

+852 3643 0807

www.qee.hk